

2016 DOWCO RAIL-LOK™ HC COVER INSTALLATION INSTRUCTIONS

Please carefully read the all of the instructions before proceeding.

Rail-Lok™ HC is designed to make the installation and removal of your pontoon boat cover easy. Your snapless Rail-Lok cover can be installed in one fluid operation by beginning at the bow or stern of your pontoon boat's fence system. These instructions will walk you through step by step instruction to ensure your cover is optimally installed to get absolute best use out of your quality Dowco product.

From Bow to Stern Installation:

Begin by removing your cover from the original packaging and locate the tag with the large word FRONT printed on it. This tag indicates the bow position of the cover which will be placed near the front of the pontoon fence.

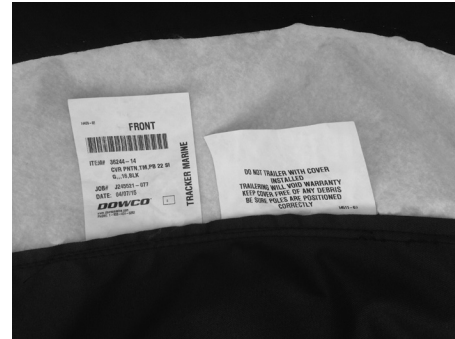

Lay the bow extension (in front of the FRONT tag) over the bow of the boat, over the front fence/rail. The bow extension will be attached at the end of the installation process.



Find the first three Rail-Lok tabs at the bottom edge (perimeter) of both sides of the cover and slip those into the slot located on the underside of the mid rail of your pontoon fence.

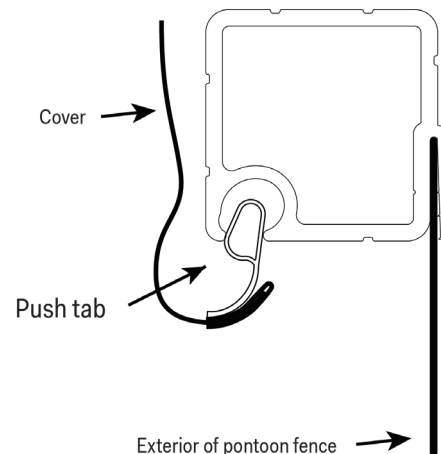

Rail-Lok HC Installation Instructions

Install the first pole by locating the first pole pocket (located closest to the bow), insert the pole in the pocket, extend the pole until there is adequate tension on the cover. Continue by inserting the next several Rail-Lok tabs on each side of the cover until you get to the next pole pocket. Repeat the pole install. Continue working toward the stern exit gate of the boat. After installing the final pole, exit through the rear gate and finish inserting the remaining Rail-Lok tabs.

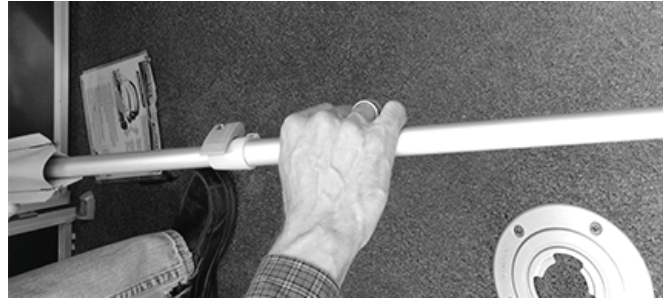

NOTE: Rail-Lok is designed to work under tension thus the process for placing poles after the Rail-Lok tabs are secured which keeps the tension lower during insertion of the Rail-Lok.

Next lace the stern corner straps through the cleat on each side and pull snug.

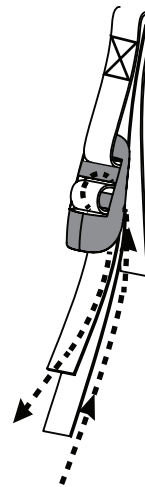

Once you exit the boat, go to the bow to complete installation by attaching the bow extension.

Locate the webbing clip attached at either side of the cover and attach to the nearest aluminum deck support cross member under the pontoon deck.

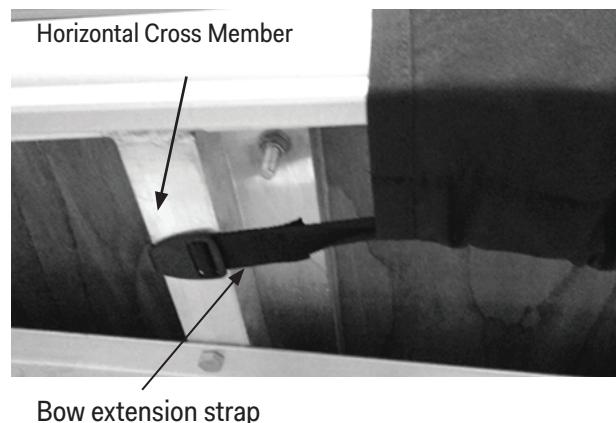

Rail-Lok HC Installation Instructions

If trailering your cover, it will be necessary to unclip both sets of side release buckles and lace them around the bow trailer bumpers and re-clip each side. Attach the forward trailering safety straps located at each side of the trailer bumper cutaway to the horizontal cross member located under the front of the pontoon.



In a mooring situation leave both side release buckles attached and disregard the trailer safety strap. In both mooring and trailering situations it is necessary to place adequate tension into the bow extension strap system via the side release buckle adjuster.

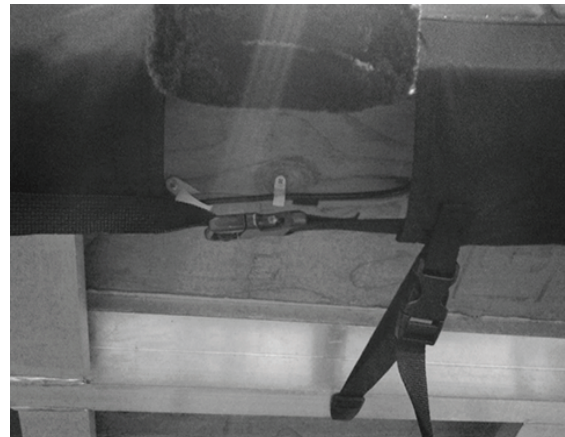

This is what the cover should look like installed. The cover fit tight to prevent water pooling and for optimal air management when trailering.



Rail-Lok HC Installation Instructions

Cover Removal:

Start the removal process at the stern. Detach stern trairling straps. Release tension on the pole closest to the stern to relieve tension on the Rail-Lok tabs. Moving evenly from stern to bow, release the Rail-Lok tabs on each side of the boat. To release each Rail-Lok tab, grasp the outer edge of the tab and pull at a diagonal angle downward to unlock the tab from the rail of the boat. Continuing releasing Rail-Lok tabs and removing poles until you reach the bow. Roll your cover up as you move toward the front of the boat. When you reach the bow, unlatch the bow mooring and trairling straps and remove the cover from the boat.

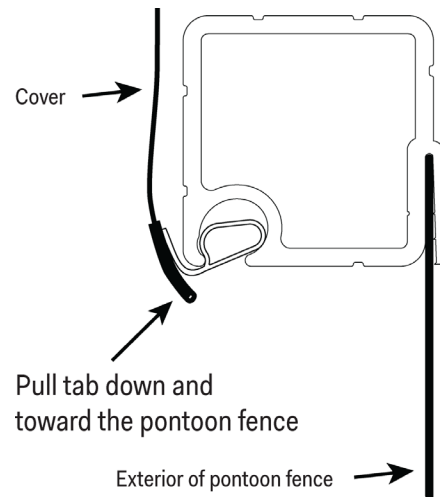

Troubleshooting:

While you are inserting the tabs into the rail, keep the cover taught as you make your way to the back of the boat. If the flap cutouts do not line up you may need to pull on the cover to get them lined up.

For additional information or questions about installation or use of this cover, please contact your dealer or Dowco at dowcomarine.com or call (800) 404-5252.